

Congratulations with your new Zeromix faucet containing 0.0 % lead

 0-PERCENT 

You have chosen a faucet that is good for the environment as well as for your health. In this way you can continue to let your family drink the water direct from the faucet with a clear conscience, without having to fear neither lead poisoning nor nickel allergy because of the polluted water.

The faucet is naturally approved, however we actually make much higher demands to this mixer faucet as prescribed in any EU legislation.

The faucet is supplied with a “smoke-coloured” basic ring in order that your guests can immediately see that it is a faucet containing 0.0 % lead, and in this way signalling that it is possible to drink the water direct from the faucet.

If you do not want to “display” your healthy and environmentally correct choice, you can exchange the smoke-coloured ring with the attached O-ring. Now the mixer faucet can be installed directly on your work top / vanity top.

Before installation:

Before you dismantle the old faucet, please remember to shut off the water-mains by the main valve. Please check at the same time that the valves can be easily opened / closed; if this is not the case, it must be changed with new, as deposits can come loose and damage your new faucet.

Stop valves with filters must be used in order for the guarantee of non-drip function to be valid.

Installation:

Diameter of mounting hole must be minimal 34 mm and maximal 37 mm.

This delivery contains copper installation pipes; please bend and form these gently with your hands in order to fit your existing pipes. If shortening of the pipes is needed you must use a tube cutter – if you use a hacksaw, it is

important that all burrs and chips are carefully removed, as they will damage the internal parts of the faucet, causing the faucet to drip. By installation, the pipe ends must be intruded approx. 1,5 cm into the fittings.

N.B. Please don't replace the copper installation pipes by non-copper tubes, as these might contain lead. For a proper installation please follow the Zeromix manual.

After installation:

Before you open the water supply, dismantle the air mixer jet/filter, and turn on as well the cold as the hot water of the faucet.

Now you SLOWLY open the stop valves; if you open too quickly, dirt might come loose, damaging the shut-off part of the mixer faucet. This may cause the mixer faucet to be leaky.

After a while you can turn off the water on the faucet, and then mount the air filter again.

Maintenance/Cleaning:

Do not use corrosive or abrasive solvents.

In case of faucets with swivel handle we recommend to lubricate the rubber seal (the point where the handle is in contact with the faucet) with special faucet lubricant.

Guarantee:

In general Zeromix faucets enjoy a 5 year guarantee period for all metal bodyparts. The cartridge enjoys a 1 year guarantee period. The guarantee becomes void if NON approved components are used in the installation.

The guarantee does not cover frost damage. The guarantee becomes void if missing filters or missing maintenance of filters cause impurities to get into the faucet.

For further detailed guarantee conditions please visit our website; these conditions apply to your purchase of any Zeromix faucet.

Defects:

In case of defects, please contact the dealer, where you purchased the mixer faucet. Please remember to bring your receipt.

Best regards www.zeromix.nl

Washbasin Mixer

BRAHMS/ STRAUSS

Washbasin Mixer

VIVALDI

Washbasin Mixer High

BRAHMS/ STRAUSS/
VIVALDI

Kitchen Mixer

BRAHMS/ STRAUSS/
VIVALDI

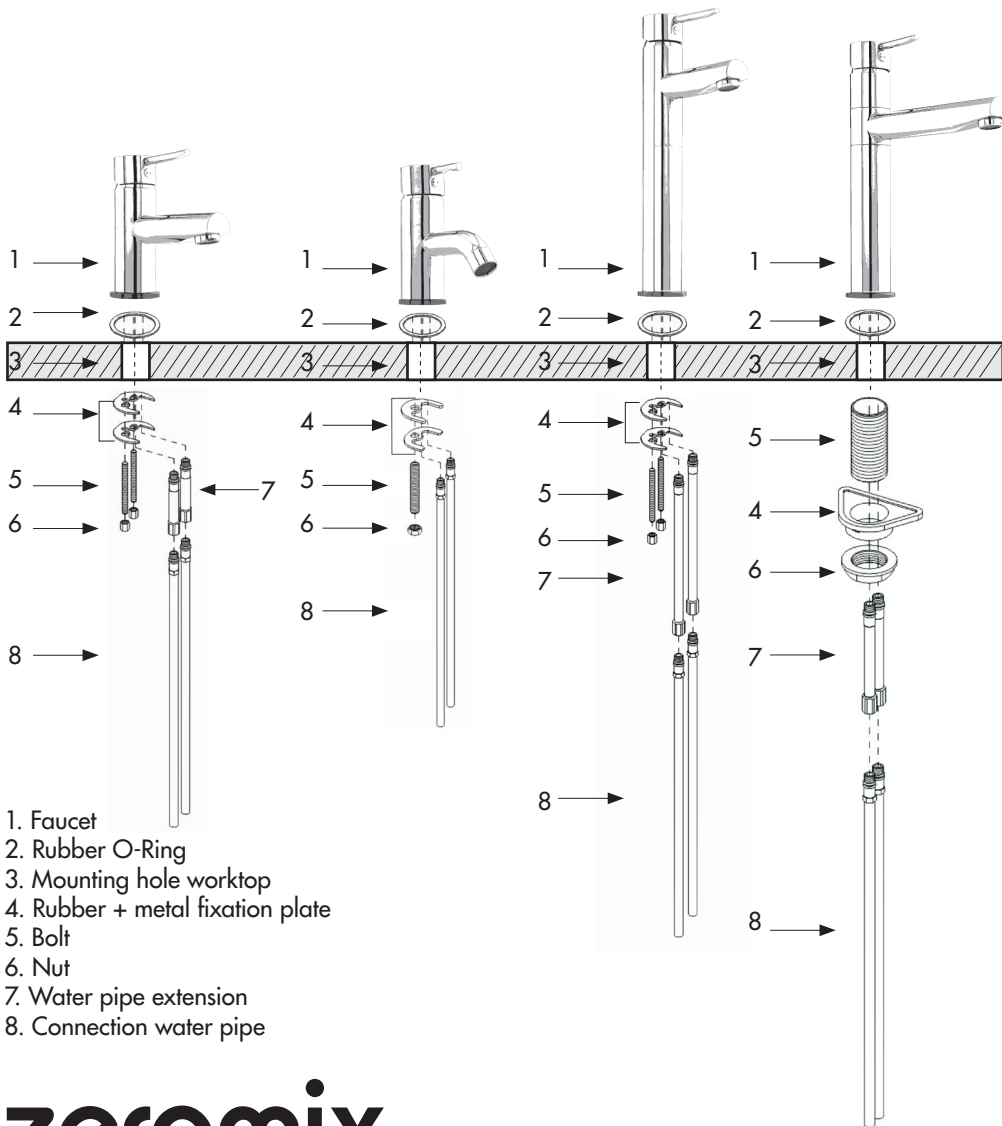

1. Faucet
2. Rubber O-Ring
3. Mounting hole worktop
4. Rubber + metal fixation plate
5. Bolt
6. Nut
7. Water pipe extension
8. Connection water pipe

zeromix
lead-free faucets

De Overmaat 78 - NL 6831AJ ARNHEM - THE NETHERLANDS
Phone +31(0)26-3195167 - Fax +31(0)26-3195163
www.zeromix.nl - info@zeromix.nl

BRAHMS
STRAUSS
VIVALDI